



RESIDENTIAL ESTATE AGENTS
PROPERTY LETTING & MANAGING AGENTS
VALUERS & PROPERTY CONSULTANTS
CHARTERED SURVEYORS

01722 336422
www.hwwhite.co.uk WEB



Wilton Terrace, Shipton

£950 PCM

4 Wilton Terrace, Shipton Bellinger, Tidworth, Hampshire, SP9 7UJ



Energy Efficiency Rating		Current	Potential
Very energy efficient - lower running costs			
(92 plus) A			83
(81-91) B			
(69-80) C			
(55-68) D		56	
(39-54) E			
(21-38) F			
(1-20) G			
Not energy efficient - higher running costs			
England & Wales		EU Directive 2002/91/EC	

A well presented, 3 bedroom, 3 storey Victorian mid terrace cottage traditionally built with red brick elevations under a pantile roof. Redecorated and re-carpeted in 2023, the accommodation comprises a front sitting room with a feature fireplace, central dining/living room with a wood burner leading to a galley style kitchen with free standing electric cooker and space for under counter fridge. Rear lobby with cupboard, plumbing for washing machine and door to garden. This leads through to a ground floor bathroom with thermostatic shower over bath with folding screen. Stairs off the central living room to the first floor with front double bedroom with built-in cupboard and a walk-through rear bedroom 2 having stairs up to a spacious attic bedroom 3. Outside there is an enclosed rear garden, mainly lawn with shed and gate to pedestrian access along the back of the row of cottages for putting out rubbish bins/bike access etc. Enclosed front garden with lawn and path to wooden front door. The property has the latest generation of electric Quantum heaters to compliment the wood burner. One allocated parking space at the end of the terrace. The property is neutrally decorated and carpeted and is available UNFURNISHED, potentially on a long term basis. Tenants must look after the garden.

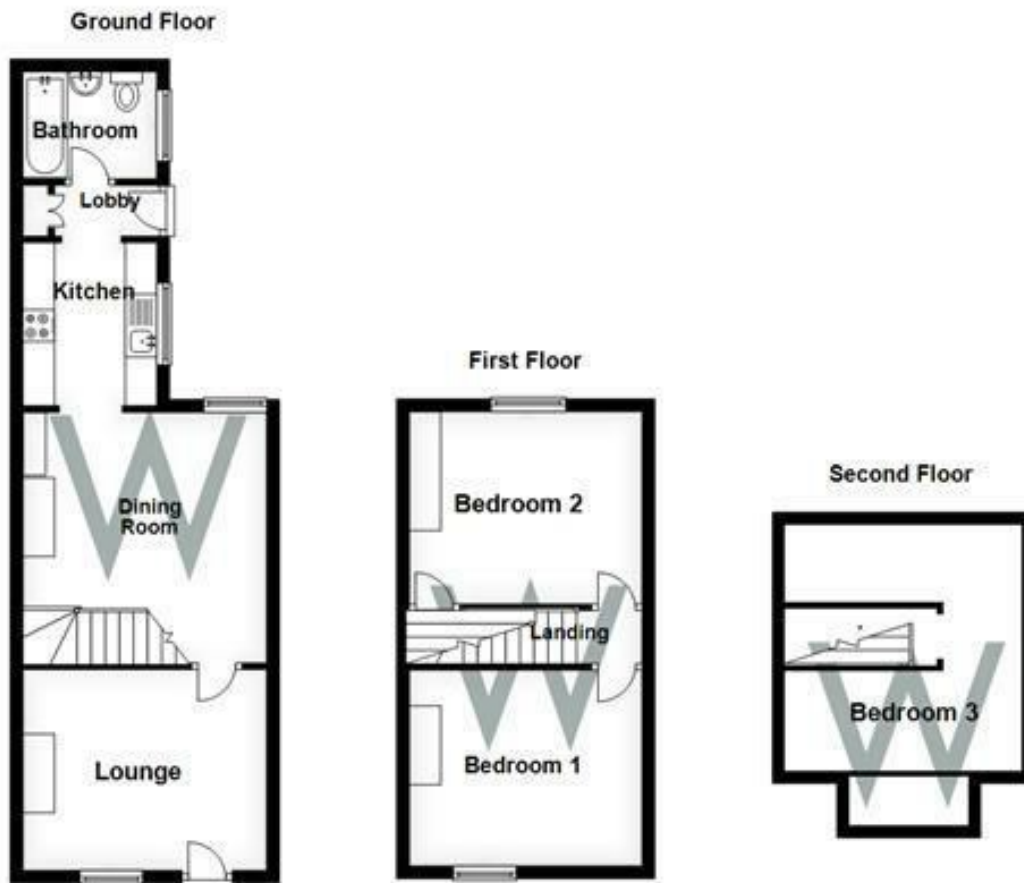

01722 336422

47 Castle Street, Salisbury SP1 3SP 01722 320600 FAX
 residential-sales@hwwhite.co.uk E.MAIL www.hwwhite.co.uk WEB